



SafeGUARD
WINDOW & DOOR SYSTEMS

FIVE-STAR PERFORMANCE, FIVE-STAR STYLE
Aluminium Windows and Doors

We're not all the same

Every one of us is unique with our own personal blend of character and taste. We might follow fashion, or we might choose to break out of the mould, but often we compromise and settle for ordinary. That's why some homes can feel a little disappointing. We live with someone else's choice of door. We tolerate serviceable windows, accepting second best when what we really want is something as exceptional as we are.



**Safeguard is about
refusing
to compromise.**



**Safeguard is about higher
standards.**



**Safeguard is about
strength, style
and performance.**

Safeguard is adaptable. It's a window and door system that redefines glazing in a way that allows you to be an individual. Your colours, your finishes. Layouts that suit the way you live. Bold, subtle, brave or understated, it's up to you.

And even though it's an outstanding system, Safeguard doesn't steal the show. It has some of the slimmest sightlines on the market, allowing your view to take centre stage. The glass area in windows and doors is maximised and your home is filled with light. Safeguard isn't demanding. Maintenance is simple, and it will last for years. Safeguard insulates your home, protects it and enhances it.

Safeguard is resilience without weight. It's elegance without effort. It's extraordinary, but then, so are you.



Why Safeguard?

Safeguard is, simply, an outstanding system

Unlike many aluminium window and door systems, Safeguard isn't a compromise. It accepts no limitations and the result is the best aluminium system for the UK's homeowners.

Safeguard is amongst the slimmest systems in the industry, with some sections 30% narrower than the nearest alternative. The slim sections maximise the glass-to-frame ratio, improving views and letting more light into your home.

Safeguard also includes a revolutionary, patented design feature, unique in aluminium systems. The reverse butt joint ensures Safeguard can always be glazed from the inside without spoiling its amazing lines with dummy window sashes.

Safeguard is the system with the light touch on the planet. It uses less material than other systems, saves energy in your home and is responsibly produced, with a Green Guide A rating. It can reach Band A thermal performance with triple glazing. It meets or exceeds all legal requirements for thermal efficiency, ventilation and security as standard for complete peace of mind.

And it has looks that work in all types of property, ultra-modern and traditional.

SafeGUARD
WINDOW & DOOR SYSTEMS





Why aluminium?

We've known for decades that aluminium is a remarkable material. It's plentiful, strong, corrosion resistant and 100 per cent recyclable. It's used for everything from soft drinks cans to aircraft manufacture and is now the material of choice for windows and doors.

In the 1970s and 1980s, early generations of aluminium glazing appeared on the market. Frankly, those windows and doors are best forgotten. The styling dated quickly, and insulation was poor. It's no wonder those who had rushed to replace their old timber frames went looking for an alternative and chose PVC-U.

But in the intervening years, aluminium systems for glazing improved beyond recognition. Now aluminium sections are purpose made. They incorporate the latest thermal break technology. They're produced with tough, long lasting powder coated finishes. They're designed to keep the weather and intruders at bay, but perhaps the biggest advantage comes from their strength.

Aluminium's inherent strength allows windows and doors to be made with super-slim frames. And when there's less frame, there's more glass, more light and better views. Another benefit is that frames can be larger, without the need for expensive reinforcing. That's why aluminium is perfect for today's architecture and its wide expanses of glass. It's simply ideal when there's a large gap to span.

Aluminium frames are long-term performers. The material is resilient, durable and will last for decades with minimal maintenance and if, eventually, the frames need to be replaced, the aluminium can be recycled.

All things considered there's nothing to beat aluminium for windows and doors.



Part of the **architecture**

For too long, windows and doors have been a secondary consideration in homebuilding. It makes no sense when our living spaces and the way we use them are fundamentally altered by light. Now, though, with aluminium, the possibilities are, often quite literally, opening up.

Rooms don't have to be dark and gloomy to be warm and comfortable. With aluminium frames, stairwells can be flooded with natural daylight. Walls can be replaced with full expanses of insulated glass. This is the 21st century – if you want to entertain, slide back the glass and open up your home.

Perfect harmony

Installing Safeguard windows or doors is where the real magic begins because Safeguard is form and function in perfect harmony. Its aluminium profiles allow us to make slimmer frames. We can have clean crisp lines and simplified shapes. It allows us to have weather protection without the chunky overlap of most timber or PVC-U windows.

Manufactured to your bespoke size and specification and fitted with sympathetic hardware designed to suit the frame colour – Safeguard is the system that can disappear into your architecture – it's slim enough to be unobtrusive – or bold enough to be a statement with a dramatic splash of colour or a transom line that draws the eye.

Enjoy

Every minute you waste wishing for something better could be one you spend enjoying something better.

Safeguard gives you lots more opportunities to enjoy living, and because it's so simple to care for, you won't waste your precious time on maintenance chores.

Life's short. What are you waiting for?

Safeguard by name, **Safeguard by nature**



Less frame, more light

Safeguard's frames are typically considerably slimmer than industry competitors. That gives you more glass, less frame to interrupt the view, and more natural daylight in your home.



More affordable and more sustainable

Safeguard uses approximately 30% less aluminium than comparable systems. It's therefore more affordable, more sustainable and less likely to generate waste.



Easy to care for

Safeguard needs very little maintenance. Its shapes and lines are simple and easy to clean, and its tough coating stays looking great year after year.



Thermal performance

Strong aluminium sections allow large glazed areas, while advanced thermal break technology ensures no compromise on insulation. Safeguard can be double or triple-glazed and can reach Band A rated and U-values as low as 1.1 W/m²K.



Robust protection

Safeguard's internally glazed frames enhance security, backed by advanced hardware, locks and hinges. Even in exposed locations, it protects your home from the elements, it protects your home from the elements, and a range of door thresholds keep you weatherproof, allowing easy access for those with impaired mobility.



Cleaner lines and adaptable styling

Safeguard windows have clean sight lines both inside and out. This aesthetic was designed to provide contemporary styling to our products that will enhance most house types.





Staying safe

Safeguard is an advanced system designed to meet or exceed all the standards laid down in the Building Regulations. It's engineered for structural strength and to provide protection for your home from the weather. Heat, rain, wind and cold can do their worst, but you and your home will stay safe and warm.

We haven't simply thought about the fabric of your home, though. We've thought about those who live there. Safeguard doors and windows can incorporate all the features you'd expect, including night ventilation, egress hinges in case there's a fire, or child safety restrictors to ensure little ones can't take a tumble through a wide-open window. Even our bifold doors have guards so that fingers don't get pinched.

Staying secure*

Sadly, break-ins happen, but that doesn't mean we can't be proactive about prevention. Burglars like an easy life and we won't give them one with Safeguard.

Doors and windows are fitted with multipoint locking technology, which provides protection all around the frame. Hinges are concealed so they can't be targeted and Safeguard accommodates the latest high-security locks from Yale, the trusted home security specialist. Kitemarked and approved, these locks can't be picked, drilled, pulled, snapped or bumped.

It's a comprehensive approach to security – folding doors incorporate shootbolts that secure each pane while sliding doors cannot be prised from their tracks. It surpasses the requirements of PAS 24 – the recognised standard for glazing security. What's more, we've developed Safeguard to meet the exacting standards of the Secured by Design scheme which aims to deter opportunistic thieves.



Secured by Design



Official Police Security Initiative

* Selected products only. Ask your sales advisor for details.





The proven performer

Aluminium systems have come a long way since their earliest days. Now, Safeguard is pushing standards even higher, with insulation and weather protection a fundamental part of the design, not an afterthought.

Window Energy Ratings

In windows, insulating performance is calculated using a mixture of air leakage, solar gain and thermal transmittance. Combining the three calculations can get complicated, but they've been simplified into a single measure known as a Window Energy Rating or WER.

The performance depends on several variables, including the layout and size of the window and the choice of glass. Safeguard offers a choice of double or triple glazing, and with triple-glazing can reach an A rating for outstanding energy efficiency (values based on the casement range).

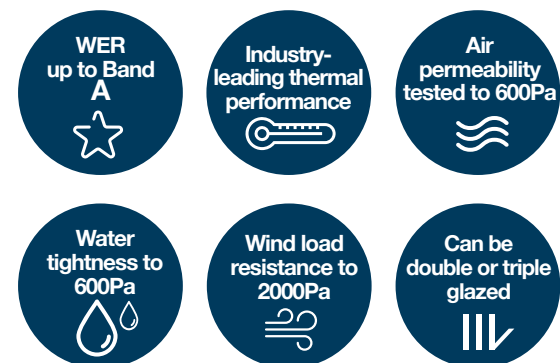

Let's talk about the **Reverse Butt Joint**

Forgive us for diving into window jargon, but the reverse butt joint is something unique to Safeguard and is one of the features that makes it so special.

Glass in a window frame is held in place by a bead. For security, it's better that the bead is on the inside. When a fixed pane is situated next to a pane that opens, the ideal is to reverse the frame so that the opening pane fits snugly against it. This is straightforward with PVC-U which can be welded, and a skilled carpenter can craft a strong, neat joint in a timber frame, but aluminium frames are crimped, not welded.

The conventional way to manufacture an aluminium window is to include a dummy sash in the frame to avoid having a bead externally, but, frankly, it looks a little clumsy. There's no point choosing aluminium for its slim appearance and then adding the extra weight of a dummy opener.

And that's the problem that Safeguard's design solves.

It allows internally glazed frames that are neat and uncluttered, and which let more light into your home. It also uses less material, so it's a more sustainable design.

"Reverse butt joint" might be jargon to some people, but to those who know windows, it's a quantum leap.



The Fully Flush casement window range

The sleek Fully Flush Casement Window offers the most streamlined look on the market with flush styling for both the interior and exterior. No angles, no overlaps, just pure clean shapes and ultra-thin frames that set Safeguard apart.

Hardware has been carefully selected. In addition to reliability and durability, every lock, stay, hinge and handle contributes to the high level of security. What's more, all these practical qualities are delivered without compromising Safeguard's remarkable lines.

Again, the configuration is up to you. Replicate the pattern of opening and fixed panes in your existing frames and enjoy improved light levels, better insulation and easier maintenance or throw caution to the wind and choose a radical pared-back style. Safeguard is adaptable and will cope beautifully whatever your design ambitions.

Fixed frame windows

Not every window needs to open, and there's something very special about a window with a purpose that's purely aesthetic. With Safeguard's proportions, the frame doesn't dominate. There's more view, more light and more interest.





Functionality

- ☆ Side-hung sash – max 700mm x 1300mm
- ☆ Top-hung sash – max 1200mm x 1200mm
- ☆ Opens fully to 90 degrees



Performance

- ☆ WER up to Band A with triple glazing
- ☆ U-values as low as 1.1 W/m²K

U-values dependent on window design



Aesthetics

- ☆ Market-leading slim sightlines
- ☆ Thicker cill to replicate timber
- ☆ Needs no dummy sashes
- ☆ Flush sash
- ☆ All internally beaded as standard



Guarantees

- ☆ 10-year mechanical performance guarantee
- ☆ 10-year surface powder coat finish guarantee
- ☆ Lifetime security guarantee on hardware

Above figures relate to Fully Flush Casement Window

Flush Tilt & Turn window

The Flush Tilt & Turn Window has a strikingly slim sash that sits flush against its frame and has elegantly concealed gearing to deliver a beautifully streamlined finish. It gives you a dramatic expanse of glass that maximises light and views to create a sophisticated space that's a joy to live in. But its credentials extend far beyond its looks.

The Flush Tilt & Turn window has all the features you would expect from a window designed to offer outstanding thermal and weather performance, protecting you from the element. It has robust internal hardware with multiple locking points for reassuring security. The intelligent gearing prevents selection from tilt to turn and vice versa, enhancing safety.





Functionality

- ☆ Tilt function for additional ventilation
- ☆ Opens fully to 90 degrees



Performance

- ☆ WER up to a Band B with triple glazing
- ☆ U-Values as low as 1.2 W/m²k

U-values dependent on window design



Aesthetics

- ☆ Market-leading slim sightlines
- ☆ Thicker cill to replicate timber
- ☆ Needs no dummy sashes
- ☆ Flush sash
- ☆ All internally beaded as standard



Guarantees

- ☆ 10-year mechanical performance guarantee
- ☆ 10-year surface powder coat finish guarantee
- ☆ Lifetime security guarantee on hardware

Flush Door range

Doors need to be tough. Doors need to be secure. Doors need to be safe. But with Safeguard, doors can be strong, resilient, safe and practical without being chunky, without compromising aesthetics and without restricting the daylight in your home.

French Doors

The French door, with its symmetrical layout, has always been popular, but with the slimmest aluminium frames, it's better than ever. It's strong, of course, durable and resilient as high-quality French doors need to be, but the frame never dominates. It's the view you enjoy and the extra light that floods into your home.

Safeguard French doors have clean lines and refined elegance, but they're high performers too, insulating your home from the cold outside and from external noise. They're built to be secure and reliable with advanced locking systems from leaders in home security and finishes that are tough enough to withstand years and years of daily traffic.

Configure the doors to suit your home. They can be designed to open inwards or outwards and can be coupled with fixed panes to create a full wall of glass.





Industry-leading thermal performance

Air permeability tested to 600Pa

Water tightness to 600Pa

Wind load resistance to 2000Pa

Triple-glazing upgrades available



Residential Doors

Equally suitable for a front or rear entrance, Safeguard's residential doors are a refreshing alternative to timber, PVC-U or composite door designs. They use our super strong aluminium frames, with the same simple lines as our flush windows. Beyond that, the choice is yours – a precision-built bespoke door that will enhance your home and protect it for years.

Safeguard doors can be fully or partially glazed. There's even a purpose designed midrail which is just right if you want to include a letterbox.

These are doors engineered for strength and security. They're fitted with multipoint locking systems and can accommodate the most advanced lock cylinders. Every hardware component has been tested through cycle after cycle and every single element contributes to a secure, robust and very stylish whole. Fully compliant with PAS 24 and Building Regulations, they'll also make sure your home is protected from the elements. Effective seals keep the wind and rain outside. Our advanced thermal break technology and high specification sealed units keep the warmth indoors, and of course, if you're choosing a glazed door, we'll ensure safety glass is part of the package.

Side panel and fanlight options

Safeguard is an integrated system, and glazed side panels and fanlights – will blend in perfectly. Every proportion is just right. The same shapes, colours, and details ensure an entrance that's strong, secure, insulating, durable, easy to care for and very smart.

Internal Doors

If you need an internal door Safeguard is a fantastic choice. Unlike some systems, the flush styling works with very low thresholds, making Safeguard a great choice for connecting rooms, with the added benefit of styling that matches other windows and doors. A beautifully coordinated home is easier with Safeguard.



Dimensions

- ☆ Door leaf – max 1000mm x 2400mm



Operation

- ☆ Open-in or open-out with either full-frame or low threshold
- ☆ Part M compliant low threshold



Performance

- ☆ U-values as low as 1.1 W/m²K with triple glazing
- ☆ Meets Building Regulations
- ☆ WER up to band A+ with triple glazing



Aesthetics

- ☆ Slim sightlines
- ☆ Flush inside and out



Guarantees

- ☆ 10-year mechanical performance guarantee
- ☆ 10-year surface powder coat finish guarantee
- ☆ Lifetime security guarantee on hardware

Lift & Slide Doors

A well-designed sliding patio door can be a thing of beauty. The proportions are just right, and the frame doesn't dominate. The panes glide smoothly along their tracks, but when closed, the doors are reassuringly secure. The wind can howl but there's no trace of a draught and you can stand indoors on a frosty morning without feeling the chill. That's what happens with Safeguard. The streamlined style hides engineering that makes these sliding doors safe, easy to open and easy to secure. It's packed with technology that insulates your home. Its weatherseals are effective and long-lasting.

Why Lift & Slide?

When you're choosing to have feature glazing – that gorgeous wall of glass – your view will be interrupted by the vertical frame that marks the edge of each pane. If you reduce the number of panes, your view is better. One of the benefits of a sliding door is that each pane can be larger than on a bifolding door. It's simply a matter of weight and glass can be surprisingly heavy.

Hardware is a crucial part of any sliding door, and the Safeguard Lift & Slide Door boasts some of the very best with four locking points on the gearing.

'Lift' simply means that there's a built-in system designed to take some of the weight when you're opening the panes. It makes them glide more freely along their tracks. Safeguard has very slim frames anyway but they excel in a lift and slide design. With its incredibly slim profiles, and its 50mm interlock as standard, not only does it give you clean aesthetics, but it makes the most of maximising the glass areas, delivering the optimum amount of light into your home.



Dimensions

- ☆ Overall width max (2 pane) 3200mm
- ☆ Overall width max (3 pane) 4800mm
- ☆ Overall width max (4 pane) 5900mm.

Configuration

- ☆ 2, 3 or 4-pane layout
- ☆ 50mm interlock as standard
- ☆ Glazing options 28mm or 36mm.

Performance

- ☆ U-values as low as 1.4 W/m²K
- ☆ Multi-point locking
- ☆ Weather performance to BS6375
- ☆ Meets Building Regs.

Aesthetics

- ☆ Slim sightlines
- ☆ Contemporary design
- ☆ 50mm interlock
- ☆ No structural bonding required.

Guarantees

- ☆ 10-year mechanical performance guarantee
- ☆ 10-year surface paint finish guarantee
- ☆ 10-year mechanical guarantee on hardware.



Thresholds

When you're choosing a door designed to make getting outside as easy as possible, you don't want to be stepping over a huge frame. Equally you need to be sure your home is protected from the weather. Safeguard has various options for thresholds, which balance easy access with features designed to prevent leaks and draughts. Some threshold systems are set into the floor, providing an almost seamless transition. Others are designed to offer easy access for wheelchairs, and for very exposed locations there are deeper threshold options developed to channel water away from your home.



Dimensions

- ☆ Up to seven sashes
- ☆ Sashes – min 750mm, max 1200mm (W). Max height 2400mm
- ☆ Maximum weight of 120kg

Slimline Bifold Doors

The attraction of a door that simply folds out of the way is undeniable. It's extra freedom in the way you use your home. It's a boon when you're entertaining, and it's wonderful on a balmy summer evening. But a bifold that isn't well built can spell trouble. The forces and the weight are considerable which is why Safeguard is ideal.

Safeguard has all the strength a bifold needs and packs a real punch with its ultra-slim sashes. Innovative thermal break technology means Safeguard is also highly insulating and meets all legal requirements for thermal efficiency as standard. The tough polyester powder coating resists damage from scuffs and day-to-day knocks.

Safeguard can be configured to your exact needs and is a fabulous example of great engineering. Its components include double hinge fixings for reliable long-term performance, multipoint locking to the main door and shootbolts for high security. There's also an outstanding track and roller system that's easy to operate and maintain, ensuring Safeguard is always reliable and always ready to impress.



Configuration

- ☆ Multiple options including left, right and both sides stacking
- ☆ Choice of access door position
- ☆ Wide choice of handle colours
- ☆ Low threshold option available

Performance

- ☆ U-values as low as 1.4 W/m²K (double glazed), 1.1 W/m²K (triple glazed)
- ☆ 28 and 36mm glazing options
- ☆ Double hinge fixing for reliable long-term performance
- ☆ Robust corner cleat system for strong precise corners
- ☆ Parallel stainless-steel tracks for ease of operation and stability
- ☆ Multipoint locking for the main door and shootbolts for high security
- ☆ Quad stainless steel adjustable rollers to spread the load evenly across multiple sashes
- ☆ Weather performance to BS6375-1
- ☆ Meets Building Regulations
- ☆ PAS 24:2016 accredited system and Secured by Design option

Aesthetics

- ☆ Ultra-slim sightlines and beautifully expansive glazed area
- ☆ Suites with other window & door systems

Guarantees

- ☆ 10-year mechanical performance guarantee
- ☆ 10-year surface powder coat finish guarantee
- ☆ Lifetime security guarantee on hardware



Colours and finishes

All Safeguard's aluminium sections are finished with a tough, durable polyester powder coat, certified to the Qualicoat standard, which surpasses European requirements.

The finishes need next to no maintenance – just a quick wipe down to remove surface dirt. Safeguard offers marine grade finish as standard to ensure outstanding resilience in even the most challenging environments.

There's a wide choice of stocked colours chosen to enhance all types of building materials.

Standard

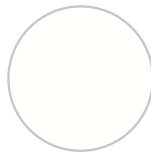

Signal White
Flat/Matt
RAL 9003

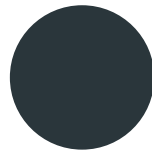

Anthracite Grey
Flat/Matt
RAL 7016



Anthracite Grey/Signal White
Flat/Matt
RAL 7016 / 9003

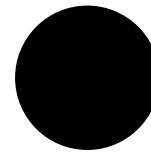

Jet Black
Flat/Matt
RAL 9005

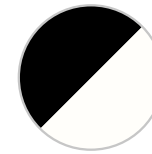

Jet Black/Signal White
Flat/Matt
RAL 9005 / 9003

Bespoke



Cream
Flat/Matt
RAL 9001

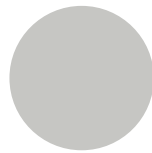

Agate Grey
Flat/Matt
RAL 7038

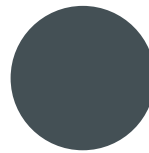

Slate Grey
Flat/Matt
RAL 7015

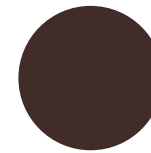

Chocolate Brown
Flat/Matt
RAL 8017

Hardware and handles

Safeguard's quality demands an equally high-quality range of hardware.

That's why in addition to choosing hardware that looks fantastic, we have selected products known for their reliability, ease of use and durability. Every item in the range has undergone rigorous testing and should give years of trouble-free operation.

Finishes have been selected for scratch resistance and durability and we only source from the most reputable suppliers so you can be sure every element is robust and reliable.



White*



Gold*



Graphite*



Chrome*



Black*

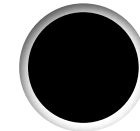

Rollers, hinges and internal handles are supplied in black.



Windows

Safeguard's fully flush windows have high-quality hardware throughout. Stays and hinges are robust and reliable. Locking systems have been chosen for long-term performance with stainless steel plates that resist corrosion. Handles are proven, stylish and benefit from key locking and easy operation. For extra peace of mind, all Yale components within the window hardware range come with Yale's Lifetime Security Guarantee.



Flush Doors

Security, weather protection and ease of use were essentials in the selection of hardware for Safeguard doors, but style hasn't been forgotten – handles match Safeguard window handles for design consistency and letterplates have clean modern looks and an immaculate finish. For security, there's a 3-star cylinder option from Yale and the reassurance of their Lifetime Security Guarantee. All door hardware is proven for long-term performance.



Lift & Slide Doors

The handle and gearing for Safeguard lift and slide doors carefully balance the needs of safety and security with ease of operation. The system benefits from proven engineering which ensures a smooth gliding action even with substantial sash weights. The most advanced lock cylinders can be accommodated, and four locking points add extra reassurance. There's also a soft-close and handle damping option for safety in use.



Bifold Doors

Hardware has been chosen for consistent styling across the Safeguard range, but every element is also robust and reliable. Double hinge fixings combine with multipoint locking for the main door. There are shootbolts for security on each folding leaf. The track system is stainless steel with four steel rollers for stability and wiper brushes to prevent debris build-up. The result is a bifolding door that opens easily and is highly secure when it's closed.

* A wide range of hardware finishes and style are available across our Safeguard aluminium window and door range. Ask your Sales Advisor for details.



The Yale Lifetime Security Guarantee

Yale is acknowledged as the leading home security brand.

Yale not only has a reputation for excellence but also offers a fantastic lifetime security guarantee on its hardware which entitles homeowners to:



**Up to £1000
towards home
insurance excess**

in the unlikely event of
a break-in.



**Up to £1000
towards repairs
or replacements**

of any failed
components.



**£1000
compensation**

if a break-in is
caused by the failure
of a Yale component
to apologise for the
distress caused.



**Up to £250 refund
on call-out fees**

if your home needs to be
secured after a break-in
resulting from a failed
Yale component.

Safeguard and Yale – the secure partnership

Together, Safeguard and Yale offer the ultimate – maximum performance and peace of mind. Combining Safeguard's gorgeous styling, its thermal insulation, its resilience, weather protection and easy maintenance with Yale's Lifetime Security Guarantee provides all the reassurance you need.

safeGUARD
WINDOW & DOOR SYSTEMS





Glass

Advanced production methods and smart technologies have resulted in glass that has insulating, solar control or even self-cleaning qualities. Combined with energy-efficient sealed units, your home can be more comfortable all year round.



Solar-control glass

Ideal for south facing rooms with large expanses of glass, solar control coatings reflect the sun's heat rather than letting it build up indoors.



Low-emissivity glass

The near-invisible coating on this glass helps to keep the sun's warmth in your home cutting your reliance on your heating system.



Self-cleaning glass

A microscopic coating helps to deter the adhesion of dirt and particulates with normal rainfall keeping the glass surface clean.



Tested and Proven

Our product development, manufacturing and fabrication are designed to ensure you get windows and doors of the very highest quality. We design, model, prototype, test and refine constantly until we're completely satisfied.

Every component is subjected to rigorous testing. Moving parts are operated through tens of thousands of cycles, windows and doors are put into test rigs and battered by 'wind' and water to ensure they can withstand nature's forces. In-house laboratories control and monitor our production. Independent agencies have verified our results.

Guarantees

When you're choosing windows and doors, you need to feel sure you're making a sound investment in your home. That's why we've engineered an outstanding system, and in turn, that's why we have no hesitation in backing our products with comprehensive guarantees.



Profile guarantee

All Safeguard's aluminium profiles have an optical and mechanical performance guarantee for a period of 10 years.



Powder coat finish guarantee

A 10-year guarantee covers the coated aluminium against the following:

- ☆ Peeling, powdering and blistering
- ☆ Corrosion except due to bending or folding after the application of the powder coat
- ☆ Chalking, fading and loss of sheen out of the Qualicoat* specification
- ☆ Filiform corrosion.

Although Safeguard is a low-maintenance product, appropriate aftercare is necessary. Failure to follow cleaning and maintenance guidelines may invalidate the guarantee.

* Qualicoat is an organisation committed to maintaining and promoting the quality of coating on aluminium and its alloys used in architectural applications. It gives purchasers the assurance of a premium grade product.

Planning Permission

In most cases planning permission won't be required when you decide to replace windows or doors, but if your home is in a conservation area, you may have certain restrictions placed on the size, style, materials and colour of the new glazing. If your home is listed, you may not be able to make changes even to the interior of your property without listed building consent. Your local authority will be happy to help.

A note about Building Regulations

These are standards for the construction of buildings laid down by the Government. Building Regulations are divided into various Parts, some of which apply to windows and doors, covering things like safety, security, ventilation, access and thermal performance. Registered installers will ensure your windows and doors are fully compliant. If you adopt a DIY approach to installation, you will need to get the work certified by your Local Authority Building Control or by an Approved Inspector.

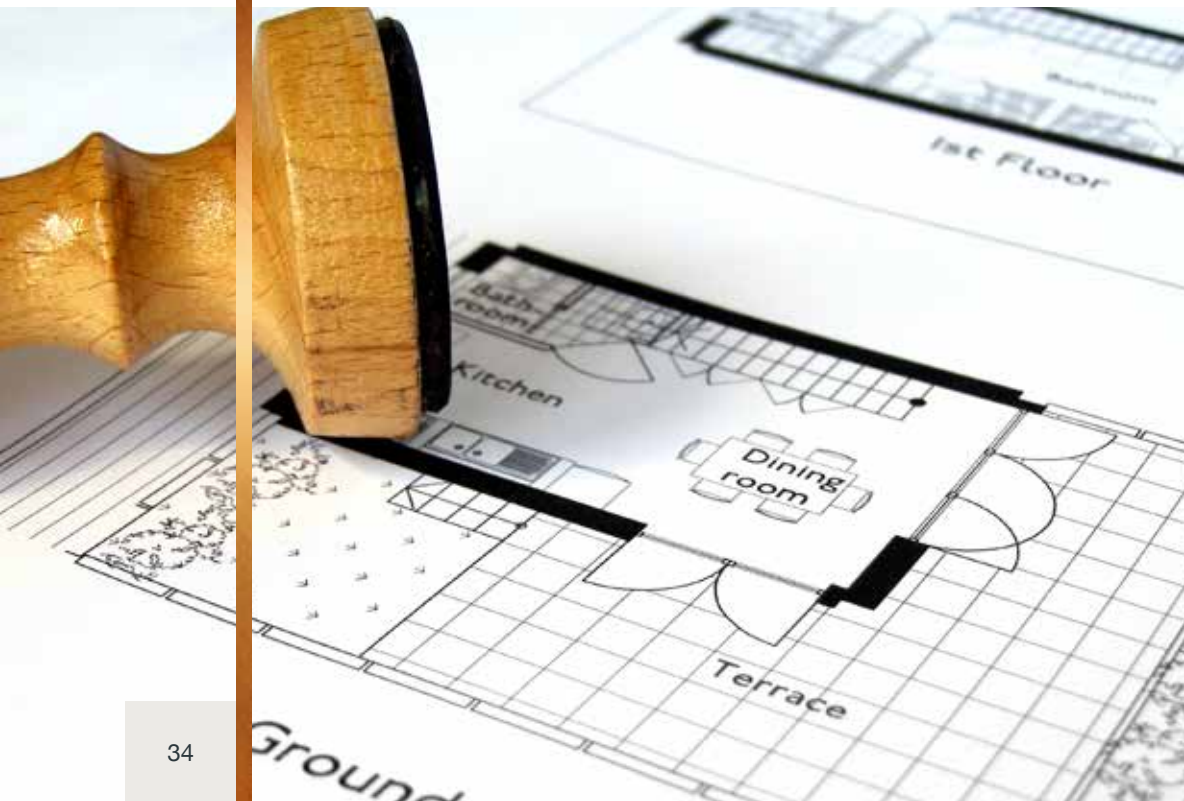

About Safeguard Windows & Doors

Safeguard windows and doors have been designed and developed by experts in glazing. With over thirty years' industry experience, our products are tried, tested and proven to perform to the highest standards..

Safeguard is strong and stable. It believes in the long-term and has invested substantially in product development, production facilities and its team, and Safeguard will continue to do so. This is a business that doesn't believe in standing still. For almost 50 years, Safeguard's innovative ideas have revolutionised window and door design and performance.

Safeguard is committed to its customers and delivers daily to an extensive network of the most reputable fabricators. It's active in industry bodies and a responsible partner in many trade and environmental focused initiatives.

Safeguard has led the way in manufacturing excellence, advanced technologies and efficiency in design. Recognising that many existing aluminium systems had compromises in style, security and performance, Safeguard chose to develop a brand-new, British designed system that wasn't hampered by preconceptions or tired ideas. The brief was a system that delivered excellence and complete customer satisfaction, and that would, like Safeguard itself, stand the test of time.

That system is Safeguard.

SafeGUARD
WINDOW & DOOR SYSTEMS





safeGUARD
WINDOW & DOOR SYSTEMS

Discover star quality at www.safeguardproducts.co.uk

Stellar Aluminium Systems is an aluminium profile system supplied to local independent manufacturers and installers who contract to install windows and doors. Stellar Aluminium cannot be held accountable for manufacture or installation by independent companies. All information in this publication is provided for guidance only and is given in good faith. As it is company policy to continually improve products, methods and materials, changes of specification may be made from time to time without prior notice. This statement does not affect your statutory rights. © Stellar Aluminium Systems. Part of the Epwin Group Plc. STE17747

