

Cladding Installation – Sequence of Work

- A. Perimeter frame battens (recommended 25 x 38mm)
- B. Battens around openings.
- C. Intermediate vertical battens.
- D. Starter trims (or bottom angle ventilation strip, as appropriate, see inset illustrations).
- E. Vertical perimeter trims, corner trims (where two-part trims are used, fix only the inner part).
- F. Top perimeter trims (These engage inside the vertical trims).
- G. Packings to battens as required for any cut planks.
- H. Plank profiles and joint covers or centre joint trims as appropriate.
- I. Outer components of two-part trims.

Note: For maximum fixing centres see important information page.

Recommended min. batten depth to create ventilation path behind cladding panels: White cladding = 25mm
Coloured cladding = 50mm

Starter Trims

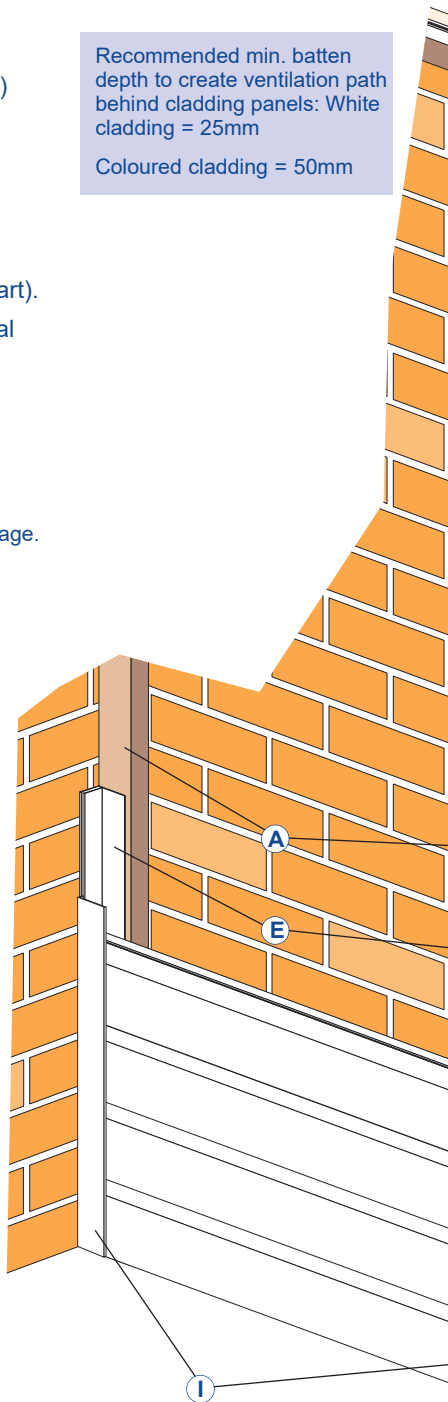
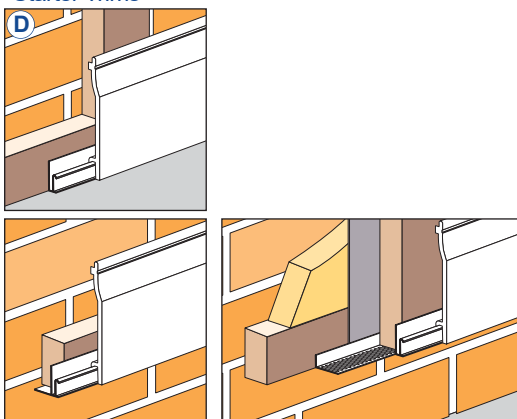

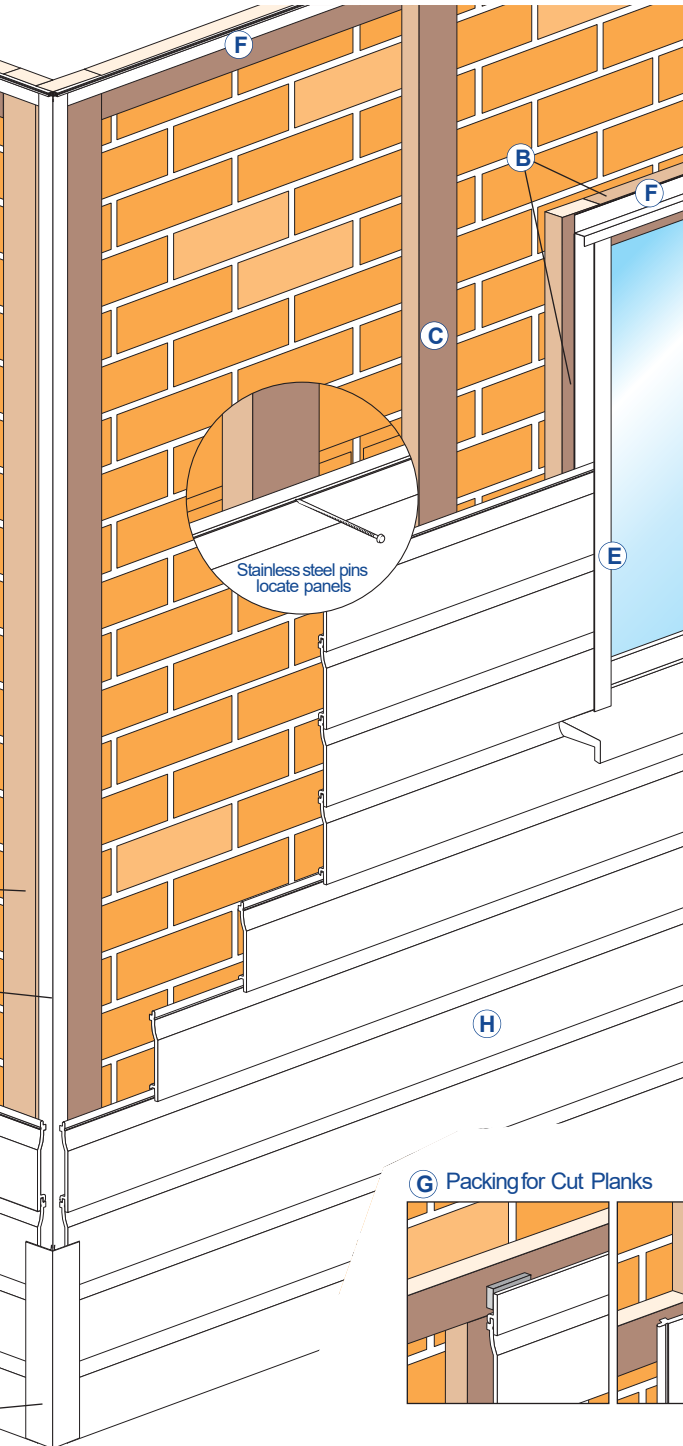

E Trim Options

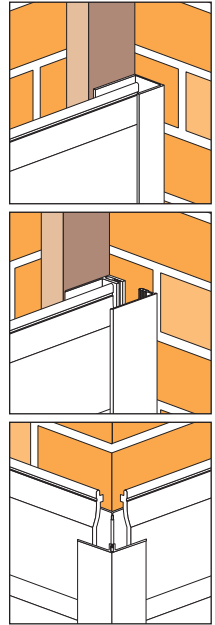

H Joint Options

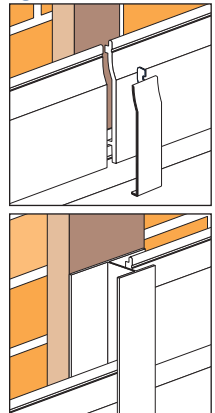

G Packing for Cut Planks

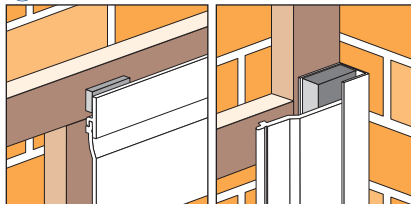

Important Information

Access Systems

SAFETY FIRST!

Never attempt to access the work area with an unsupported ladder or without a stable deck. Always use a full scaffold platform or a purpose made cantilevered deck system with guard rails in place.

Health and Safety

Full health and Safety information is available on request.

Storage & Handling

Load and unload by hand and support both ends of a 5m length when handling. Stack no higher than 1m, in packing sleeve on a flat base. Avoid contact with solvents, paint, creosote, bitumen etc.

Cutting/Shaping

Use conventional carpentry tools including fine toothed saws. Power tools may be run at speeds appropriate for timber. Nail and screw holes do not require pre-drilling.

Fascia Boards

All Concord 20mm/16mm boards and foiled boards are able to support the weight of the lower row of tiles without the need for a tilt fillet or kick plate.

Fixings

A4 grade stainless steel plastic headed nails or capped screws

Fixing Code Size Qty Max Centres

Roofline

Roofline	Fixing	Code	Size	Qty	Max Centres
16mm Fascia	Nail	C083	65mm	2	White 600mm
	Screw	C072	50mm	2	
9mm Cover Boards	Nail	C082	50mm	2	Foiled 400mm
	Screw	C071	40mm	2	
Flat Boards	Nail	C081	40mm	2	Coloured 400mm
	Screw	C071	40mm	2	

Cladding

White*	Nail	C204	30mm	1	
600mm to 2 storeys					
400mm 3- 5storeys					
Foiled*	Nail	C204	30mm	1	400mm

* Ensure plank ends are always nailed and that adequate ventilation is provided behind all foiled cladding installations

Expansion Gaps

Always leave a minimum 4mm expansion gap at the end of each board, IE where two boards meet leave 8mm overall.

Sealants

Use a low modulus silicone (BS5889 Type A). Use a primer when bonding to GRP, stainless steel, aluminium or untreated wood. Do not use with polycarbonate sheet.

Asbestos

By law all asbestos materials must be removed by trained operatives under strictly controlled conditions. If you suspect that asbestos is present you should consult your Local Authority.

Ventilation

IMPORTANT - Roof voids must be ventilated in order to stop warm air condensing on cold surfaces. Condensation encourages rot and mould growth.

Foiled cladding installations can suffer from expansion and contraction due to heat absorption, therefore it is important to provide a free air path between vertical battens. Continuity of this ventilation path can be achieved by venting into the eaves or by leaving a 10mm air gap between the cladding and soffit.

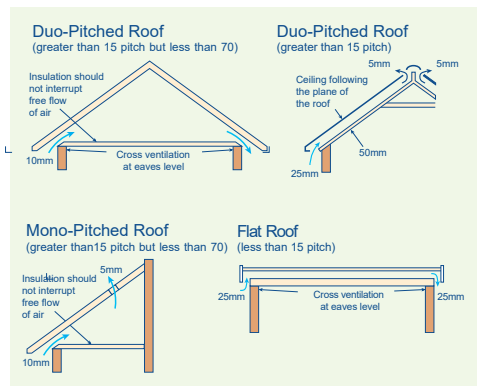

Your Local Concord Stockist



Branch Details

CAERNARFON

Zone 2, Cibyn Industrial Estate, Caernarfon, Gwynedd LL55 2BD

Tel: 01286 674 882

Email: caernarfon@eweplastics.co.uk

MOLD

Unit 7, Broncoed Industrial Estate, Mold, Flintshire CH7 1HP

Tel: 01352 752 006

Email: mold@eweplastics.co.uk

CREWE

Unit 11, Crewe Gates Industrial Estate, Crewe, Cheshire CW1 6YY

Tel: 01270 251 044

Email: crewe@eweplastics.co.uk

SOUTH MANCHESTER

Unit D10, Commercial Avenue, Stanley Green Industrial Estate,

Cheadle Hulme, Cheshire SK8 6QH

Tel: 0161 485 8901

Email: cheadle@eweplastics.co.uk